

Jonah Heaton Warrant

1/35

FORM No. 1.

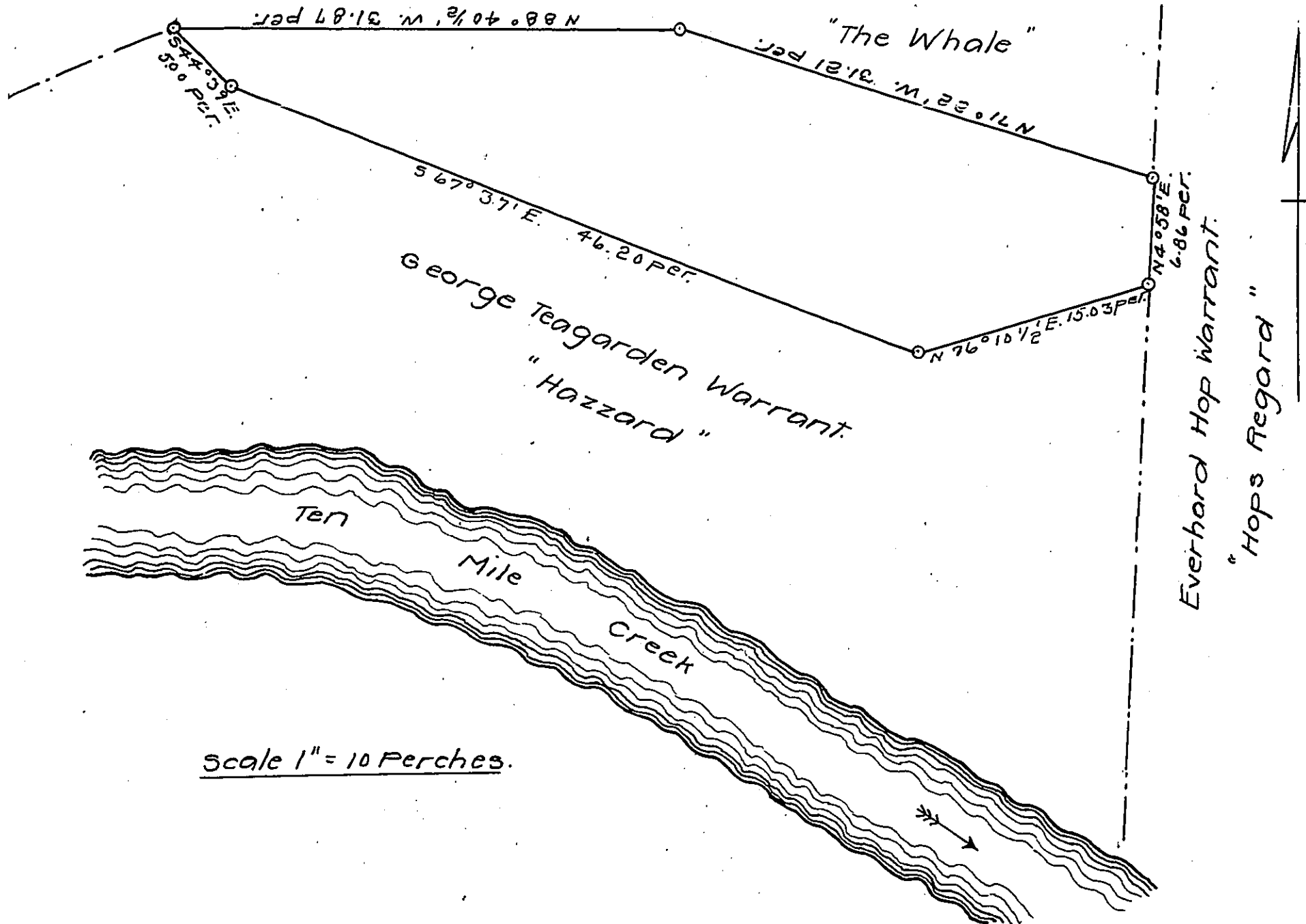

A Draft of a Tract of land situated in the Township of East Bethlehem and County of Washington, containing Three (3) acres, 126.9 perches and allowance of six per cent. for roads etc. surveyed the 23rd day of January 1920, in pursuance of a warrant granted to John Kennedy Ewing Jr. dated the 14th day of January 1920.

Geo. S. Chaney.
County Surveyor.

To Hon. James F. Woodward }
Secretary of Internal Affairs }

IN TESTIMONY that the above is a copy of the original remaining on file in the Department of Internal Affairs of Pennsylvania, made conformably to an Act of Assembly approved the 16th day of February, 1833, I have hereunto set my Hand and caused the Seal of said Department to be affixed at Harrisburg, this second day of August 1920

James F. Woodward
Secretary of Internal Affairs.